

# ZigBee & RF 5 in 1 LED Controller

Model No.: WZ5

Tuya APP cloud control/Philips HUE control/Voice control/5 Channels/1-5 color/DC power socket input



## Features

- 5 in 1 function, used for control RGB, RGBW, RGB+CCT, color temperature or single color LED strip.
- DC power socket input and 5 channel constant voltage output.
- Tuya APP cloud control, support on/off, RGB color, color temperature and brightness adjust, delay turn on/off light, timer run, scene edit and music play function.
- Philips HUE APP control by connect with Philips HUE bridge.
- Voice control, support amazon ECHO and TmallGenie smart speaker.
- Match with RF 2.4G remote control optional.
- User need set light type by press key before Tuya APP network connection and match RF remote of the same light type.
- Each WZ5 controller can also work as ZigBee-RF converter, then use Tuya APP to control one or more RF LED controller or RF LED dimming driver synchronously.
- Light on/off fade time 3s selectable.

## Technical Parameters

Input and Output	
Input voltage	12-24VDC
Input current	15.5A
Output voltage	5 x (12-24)VDC
Output current	5CH,3A/CH
Output power	5 x (36-72)W
Output type	Constant voltage

Dimming data	
Input signal	Tuya APP + RF 2.4GHz
Control distance	30m(Barrier-free space)
Dimming gray scale	4096 (2^12) levels
Dimming range	0-100%
Dimming curve	Logarithmic
PWM Frequency	1000Hz (default)

Safety and EMC	
EMC standard (EMC)	ETSI EN 301 489-1 V2.2.3 ETSI EN 301 489-17 V3.2.4
Safety standard(LVD)	EN 62368-1:2020+A11:2020
Radio Equipment(REDE)	ETSI EN 300 328 V2.2.2
Certification	CE,EMC,LVD,RED

Environment	
Operation temperature	Ta: -30°C ~ +55°C
Case temperature (Max.)	Tc: +85°C
IP rating	IP20

Warranty and Protection	
Warranty	5 years
Protection	Reverse polarity Over-heat

FC CE RoHS LVD RED

## Mechanical Structures and Installations

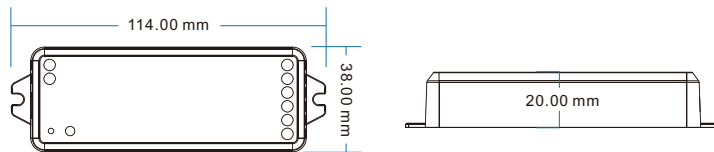
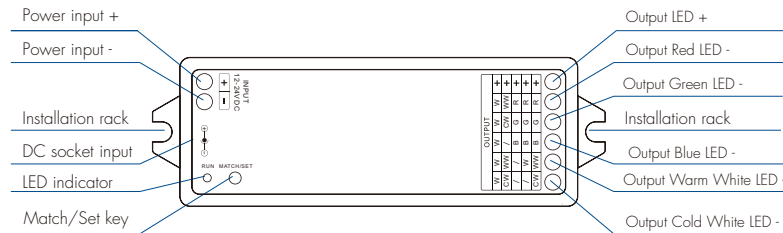

## System wiring

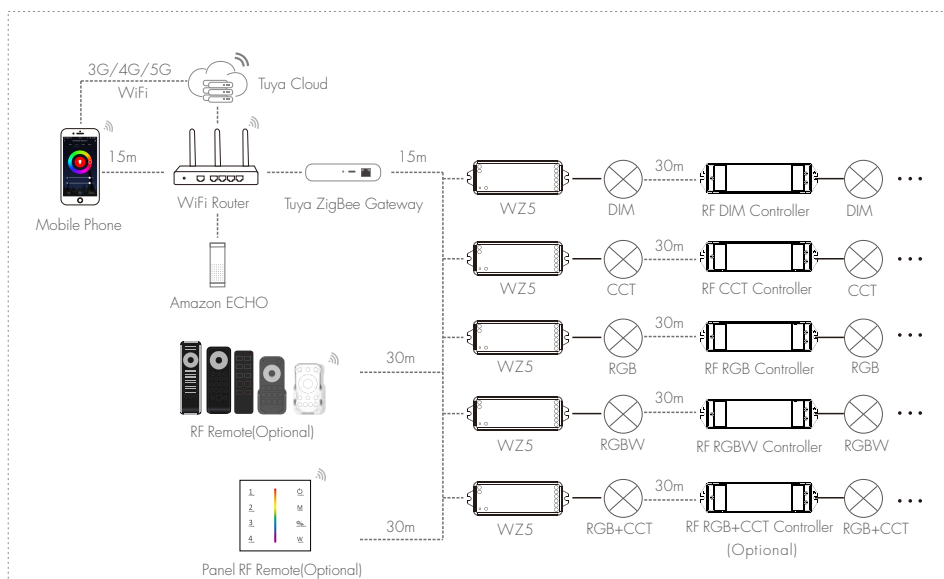

— Wired connection  
 ..... Wireless connection

- Note:
1. The above distance is measured in spacious (no obstacle) environment, Please refer to the actual test distance before installation.
  2. Users must use the Tuya ZigBee gateway to realize remote control and voice control.

## Wiring Diagram

### • For RGB+CCT

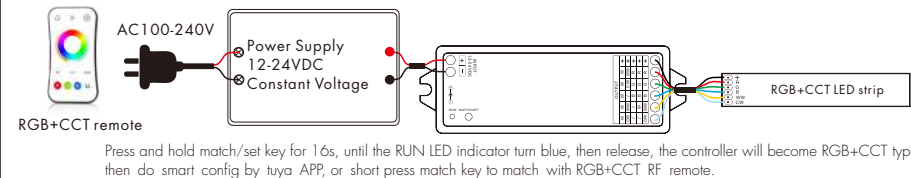

### • For RGBW

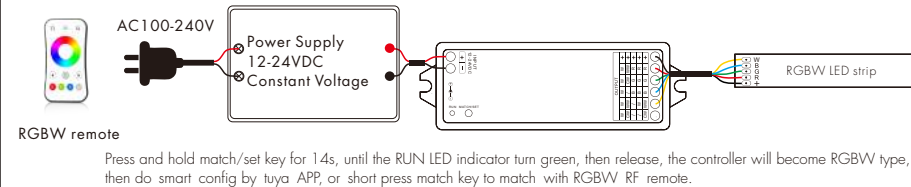

### • For RGB

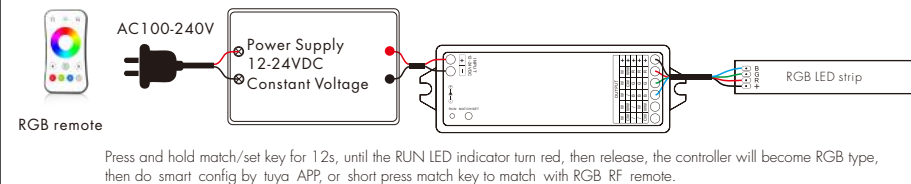

### • For dual color CCT

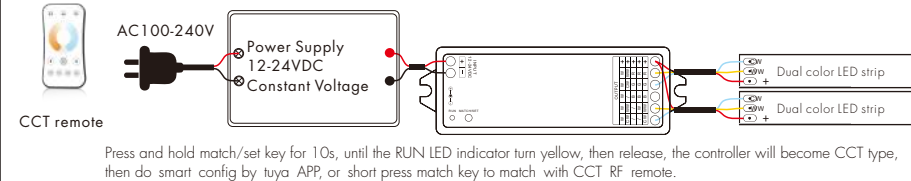

### • For single color

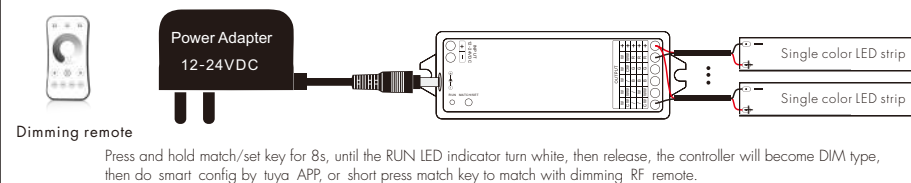

- Note:
1. User can connect constant voltage power supply or power adapter as power input.
  2. Press and hold Match/Set key for 2s, switch 5 kinds light type in sequence.
  3. For RGB+CCT or CCT light type, continuous power on and off will change 3 levels color temperature (WW, NW and CW) in sequence.
  4. Switch off the power, then switch on power, repeat again.  
 Immediately short press match key 3 times, the light on/off time will change between 3s and 0.5s.

**Tuya APP network connection**

Press and hold Match/Set key for 2s:  
Switch 5 kinds light type in sequence, notice this operation does not automatically clear previous network connection.

Press and hold Match/Set key for 5s, or push twice Match/Set key fastly,  
or when press and hold Match/Set key for 8-16s to set 5 kinds light type:  
Clear previous network connection, enter config mode, the purple LED indicator fast flash,  
the output LED will flash 10 times.

Repeat power on and off for 5 consecutive times, also clear previous network connection, enter config mode,  
the output LED will flash 10 times.

If Tuya APP network connection succeed, the RUN LED indicator will stop flash purple, and turn corresponding  
light type color (White: DIM, Yellow: CCT, Red: RGB, Green: RGBW, Blue: RGB+CCT).  
and in Tuya APP, you can find ZB-RGB+CCT device (or other DIM, CCT, RGB or RGBW).

**Tuya APP interface**

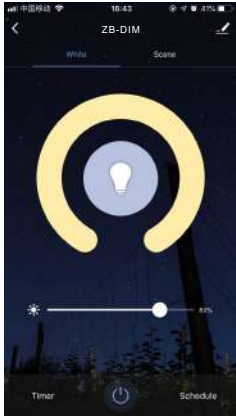

**White interface**

For DIM type:  
Touch brightness slide to adjust brightness.

For RGB type:  
Touch brightness slide, get RGB mixed white firstly, then to adjust white brightness.

For RGBW type:  
Touch brightness slide, adjust white channel brightness.

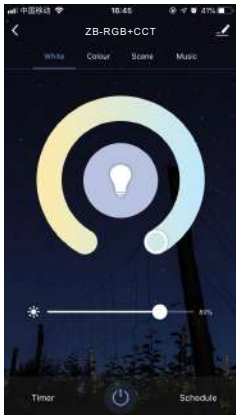

**Color temperature interface**

For CCT type:  
Touch color wheel to adjust color temperature.  
Touch brightness slide to adjust brightness.

For RGB+CCT type:  
Touch color wheel to adjust color temperature, RGB will turn off automatically.  
Touch brightness slide to adjust white brightness.



**Colour interface**

For RGB or RGBW type:  
Touch color wheel to adjust static RGB color.  
Touch brightness slide to adjust color brightness.  
Touch saturation slide to adjust color saturation,  
namely gradient from the current color to white (RGB mixed).

For RGB+CCT type:  
Touch color wheel to adjust static RGB color, WW/CW will turn off automatically.  
Touch brightness slide to adjust color brightness.  
Touch saturation slide to adjust color saturation,  
namely gradient from the current color to white (RGB mixed).



**Scene interface**

The 1-4 scene is static color for all light type.  
the inner color of these scene can be editable.

The 5-8 scene is dynamic mode for RGB, RGBW, RGB+CCT type,  
such as green fade in and fade out, RGB jump, 6 color jump, 6 color smooth.

**Music, Timer, Schedule**

The music play can use smart phone music player or micro-phone as music signal input.

The Timer key can turn on or turn off light in the next 24 hours.

The Schedule key can add multiple timers to turn on or turn off light according to different  
time periods.

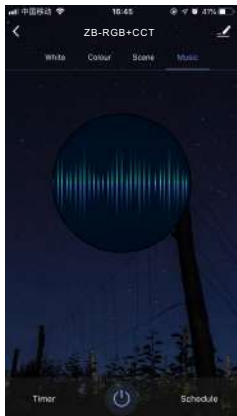

**WZ5 match remote control (Optional)**

End user can choose the suitable match/delete ways. Two options are offered for selection:

**Use the WZ5's Match key**

Match:  
Short press match key of WZ5,  
immediately press on/off key (single zone remote)  
or zone key (multiple zone remote) on the remote.  
The LED indicator fast flash a few times  
means match is successful.

Delete:  
Press and hold match key of WZ5 for 20s,  
The LED indicator fast flash a few times  
means all matched remotes were deleted.

**Use Power Restart**

Match:  
Switch off the power of WZ5, then switch on power, repeat again.  
Immediately short press on/off key (single zone remote)  
or zone key (multiple zone remote) 3 times on the remote.  
The light blinks 3 times means match is successful.

Delete:  
Switch off the power of WZ5, then switch on power, repeat again.  
Immediately short press on/off key (single zone remote)  
or zone key (multiple zone remote) 5 times on the remote.  
The light blinks 5 times means all matched remotes were deleted.

**WZ5 work as ZigBee-RF converter to match RF LED controller or dimming driver**

End user can choose the suitable match/delete ways. Two options are offered for selection:

**Use the controller's Match key**

Match:  
Short press match key of the controller,  
immediately press on/off key on the Tuya APP.  
The LED indicator fast flash a few times  
means match is successful.

Delete:  
Press and hold match key of the controller for 5s,  
The LED indicator fast flash a few times  
means match was deleted.

**Use Power Restart**

Match:  
Switch off the power of the controller, then switch on power,  
repeat again.  
Immediately short press on/off key 3 times on the Tuya APP.  
The light blinks 3 times means match is successful.

Delete:  
Switch off the power of the controller, then switch on power,  
repeat again.  
Immediately short press on/off key 5 times on the Tuya APP.  
The light blinks 5 times means match was deleted.

**RGB dynamic mode list**

For RGB/RGBW:

No.	Name	No.	Name
1	RGB jump	6	RGB fade in and out
2	RGB smooth	7	Red fade in and out
3	6 color jump	8	Green fade in and out
4	6 color smooth	9	Blue fade in and out
5	Yellow cyan purple smooth	10	White fade in and out

For RGB+CCT:

No.	Name	No.	Name
1	RGB jump	6	RGB fade in and out
2	RGB smooth	7	Red fade in and out
3	6 color jump	8	Green fade in and out
4	6 color smooth	9	Blue fade in and out
5	Color temperature smooth	10	White fade in and out